

Total Site Area (approx)
5389 sq m
1.33 Acres
0.53 Hectares

Additional Site Area (approx)
666 sq m
0.16 Acres
0.066 Hectares

- Key:**
- Proposed Trees
 - Removed Trees
 - Retained Trees
 - Extent Of ALDI Ownership
 - Additional Land Required
 - +5.22 Existing Levels

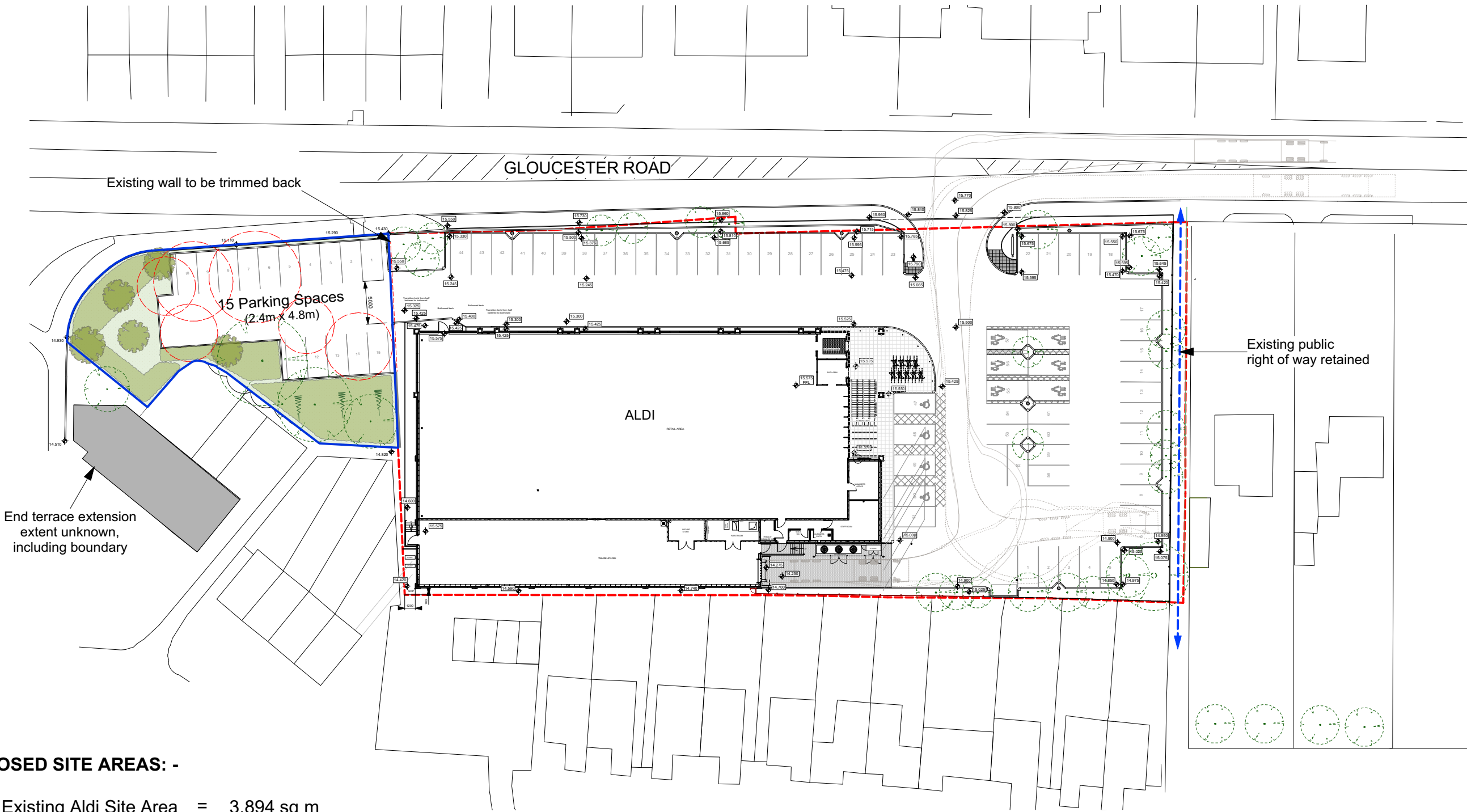

PROPOSED SITE AREAS: -

Existing Aldi Site Area	=	3,894 sq m
Additional Site Area	=	666 sq m
Total Site Area	=	4,560 sq m
Gross Building Area	=	1,510 sq m
Parking, Loading Bay, Landscaping Area	=	3,050 sq m
Existing Parking Numbers	=	64
Additional Parking Numbers	=	15
Total Parking Numbers	=	79



Chartered Architects
Chartered Building Surveyors
Interior Designers
CDM Services

Glentworth Court, Lime Kiln Close
Stoke Gifford, Bristol BS34 8SR
+44 (0)117 931 2062
www.kendallkingscott.co.uk

Project
**Aldi Stores, Gloucester Road,
Tewkesbury, Car Park Extension**
Client
Aldi Stores Ltd

Scale
1:500
Paper Size
A3
Filename
160758carparkextension.vwx
© Copyright

A 31/5/17 MWGS Car park extension amended in line with planner comments. Tree positions adjusted in line with street view.

Rev Date By Ap Note

Drawing Title
**Site Feasibility
Option 3**

Project Number Drawing Number - Revision

160758 P(0)08 A

Date
20/3/17
Drawn
AS
Checked
MW
Status
Feasibility

Check all dimensions and levels on site



0 15 30 M
Scale = 1:500